



AREA (SQ.FT)

OFFICE - 5556 SQ.FT.
 PRODUCTION - 20418 SQ.FT.
 GREENHOUSE - 21928 SQ.FT.
 TOTAL - 47902 SQ.FT.

CALCULATED FROM EXTERIOR FACE
 OF OUTSIDE WALLS AND CENTER
 POINT OF DEMISING WALLS

NORTH

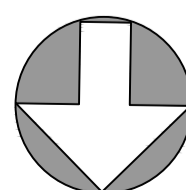

DESCRIPTION

AS-BUILT FLOOR PLANS

ADDRESS

3905 5 ST E, CLARESHOLM

MEASURED & DRAWN BY

STAN EARL

SCALE / PAGE SIZE

1/16" = 1' SCALE
 ISO A2 (594 x 420 mm)

OFFICE BUILDING
5556 SQ. FT.
9' CEILING HEIGHT

NORTH

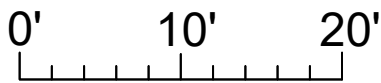
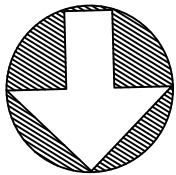

SCALE

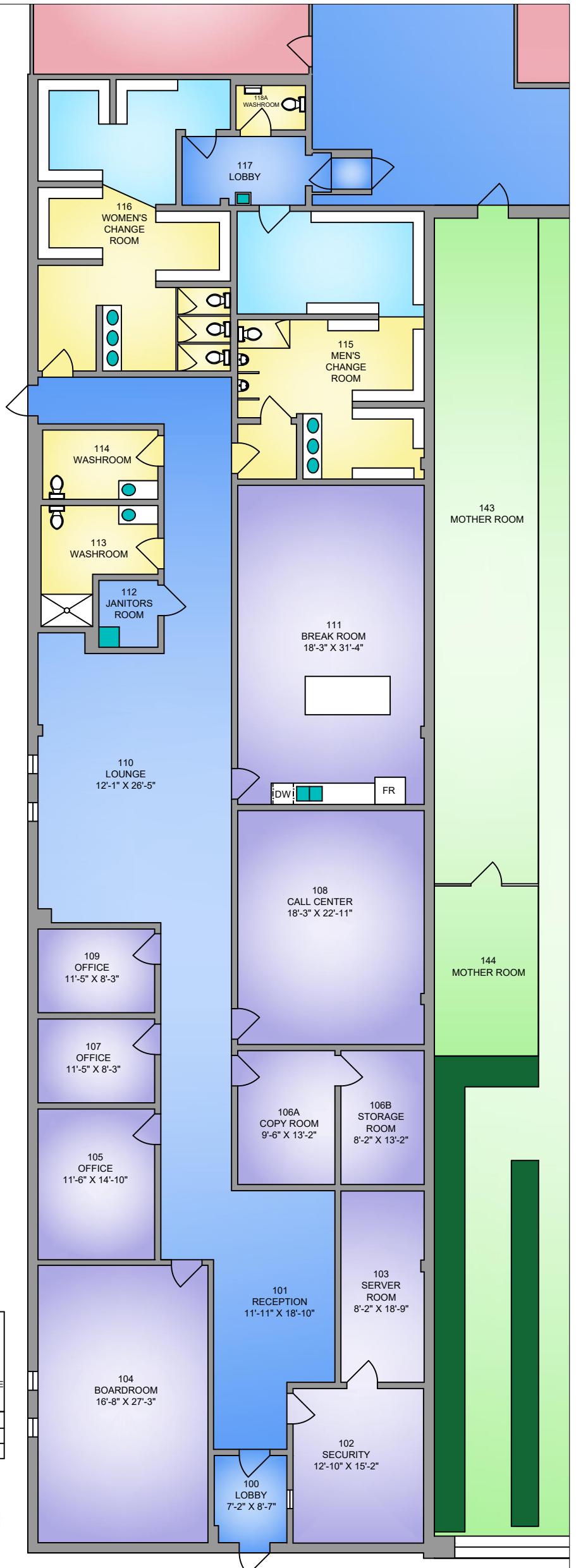

3905 5 ST E, CLARESHOLM
 OCT 2024, 2024

PREPARED BY PROPER MEASURE SOUTH ALBERTA FOR THE EXCLUSIVE USE OF
 MCDUGALL AUCTIONEERS
 THE PLANS ARE FOR REFERENCE PURPOSE ONLY, MAY NOT BE 100% ACCURATE AND ARE
 NOT SUITABLE FOR CONSTRUCTION, IF CRITICAL BUYER TO VERIFY.

FLOOR	AREA (SQ. FT.)			
	OFFICE	PRODUCTION	GREENHOUSE	TOTAL
MAIN	5556 SQ.FT.	20418 SQ.FT.	21928 SQ.FT.	47902 SQ.FT.



403-601-5920
 STAN@PROPERMEASURE.COM
 WWW.PROPERMEASURE.COM

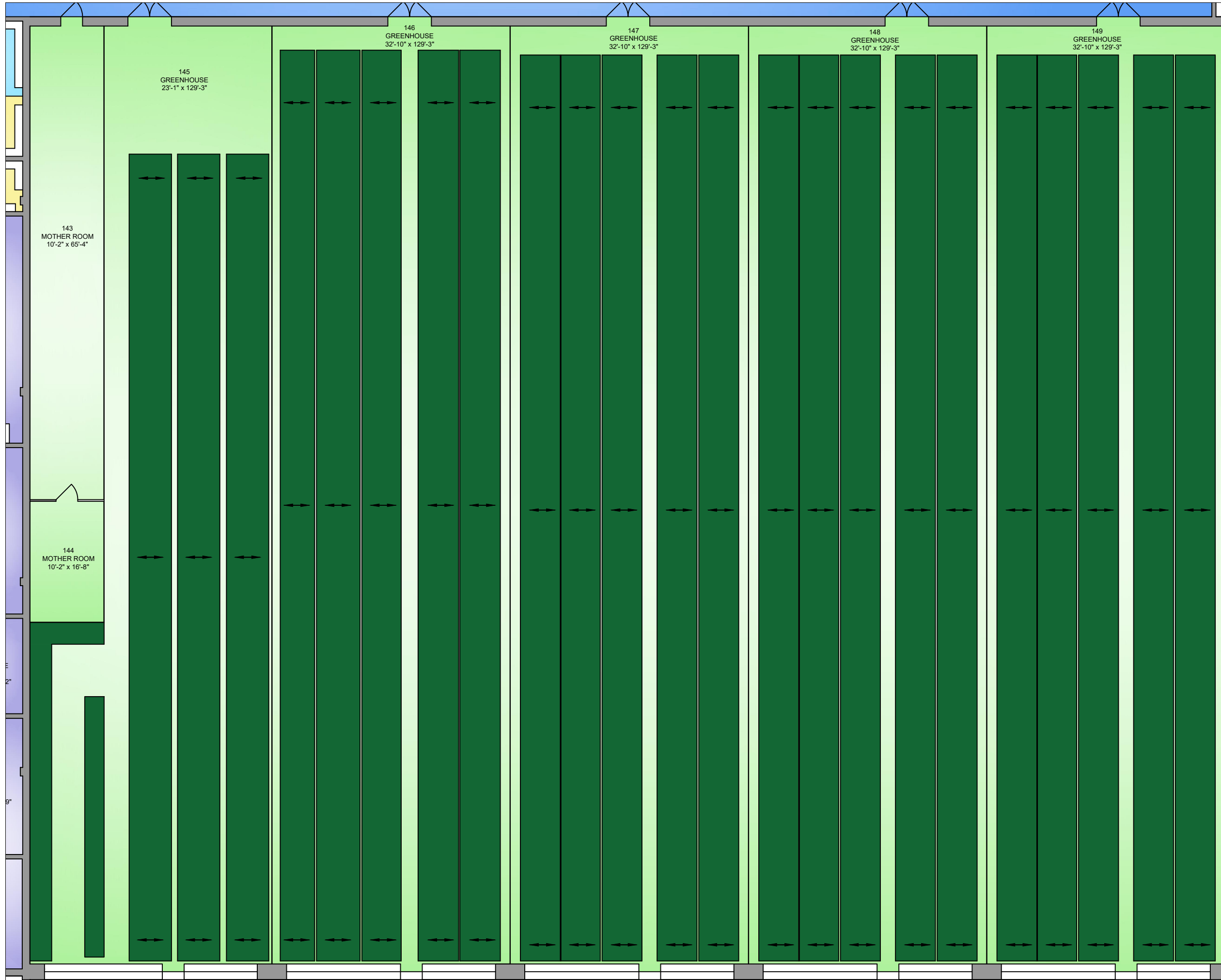

3905 5 ST E, CLARESHOLM
 OCT 2024, 2024
 PREPARED BY PROPER MEASURE SOUTH ALBERTA FOR THE EXCLUSIVE USE OF
 MCDUGALL AUCTIONEERS
 THE PLANS ARE FOR REFERENCE PURPOSE ONLY, MAY NOT BE 100% ACCURATE AND ARE
 NOT SUITABLE FOR CONSTRUCTION, IF CRITICAL BUYER TO VERIFY.

FLOOR	AREA (SQ. FT.)			TOTAL
	OFFICE	PRODUCTION	GREENHOUSE	
MAIN	5556 SQ.FT.	20418 SQ.FT.	21928 SQ.FT.	47902 SQ.FT.

PROPER MEASURE PRECISION  403-601-5920
 STAN@PROPERMEASURE.COM
 WWW.PROPERMEASURE.COM

GREENHOUSE
 21928 SQ. FT.
 16' CEILING HEIGHT

NORTH

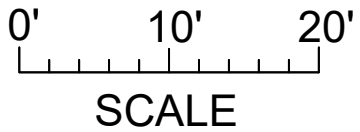
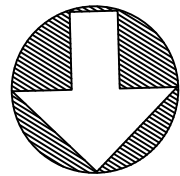

3905 5 ST E, CLARESHOLM
OCT 2024, 2024

PREPARED BY PROPER MEASURE SOUTH ALBERTA FOR THE EXCLUSIVE USE OF
MCDUGALL AUCTIONEERS
THE PLANS ARE FOR REFERENCE PURPOSE ONLY, MAY NOT BE 100% ACCURATE AND ARE
NOT SUITABLE FOR CONSTRUCTION, IF CRITICAL BUYER TO VERIFY.

FLOOR	AREA (SQ. FT.)			
	OFFICE	PRODUCTION	GREENHOUSE	TOTAL
MAIN	5556 SQ.FT.	20418 SQ.FT.	21928 SQ.FT.	47902 SQ.FT.

PROPER MEASURE™
PRECISION

403-601-5920
STAN@PROPERMEASURE.COM
WWW.PROPERMEASURE.COM

PRODUCTION BUILDING
20418 SQ. FT.
10' CEILING HEIGHT

NORTH

