

SASKATCHEWAN LAND SURVEYOR'S REAL PROPERTY REPORT

To: [REDACTED]
[REDACTED]
[REDACTED]

Attention: [REDACTED]

RE: Lots 19-26, Block 18, Plan S1896
Moose Jaw, Saskatchewan

Date of Title Search: 13-Oct-2017

Legal Description	Registered Owner	Easements
Surface Parcel #104130458 (Lot 19, Block 18, Plan S1896)	[REDACTED] Active Surface Title #143763802	None Registered
Surface Parcel #104143272 (Lot 20, Block 18, Plan S1896)	[REDACTED] Active Surface Title #143763835	None Registered
Surface Parcel #104143261 (Lot 21, Block 18, Plan S1896)	[REDACTED] Active Surface Title #143763846	None Registered
Surface Parcel #104143250 (Lot 22, Block 18, Plan S1896)	[REDACTED] Active Surface Title #143763868	None Registered
Surface Parcel #104143249 (Lot 23, Block 18, Plan S1896)	[REDACTED] Active Surface Title #143763879	None Registered
Surface Parcel #104143238 (Lot 24, Block 18, Plan S1896)	[REDACTED] Active Surface Title #143763891	None Registered
Surface Parcel #104143227 (Lot 25, Block 18, Plan S1896)	[REDACTED] Active Surface Title #143763914	None Registered
Surface Parcel #104143216 (Lot 26, Block 18, Plan S1896)	[REDACTED] Active Surface Title #143763947	None Registered

I, Jared M. Adams, Saskatchewan Land Surveyor, have made a survey of the above-described property between the 18th day of October, 2017 and the 20th day of October, 2017, and hereby certify that:

1. This plan forms a Real Property Report prepared in accordance with Article No.XIII of the bylaws of The Saskatchewan Land Surveyors Association.
2. The permanent building(s) now situated on the above-described property is(are) located as shown on this plan.
3. There are no encroachments above ground unless shown.
4. Measurements shown are to main exterior walls of all structures unless noted.
5. This document provides data for mortgage purposes and for the use of the Municipal Building Department and should not be used for any other purpose.
6. Subsurface structures are not shown.

Dated at Regina in the
Province of Saskatchewan
This 23rd day of October, 2017.

2017 ©



This document may not be reproduced without the written consent of the certifying Land Surveyor; further, it represents the conditions shown on the date of certification only.

SASKATCHEWAN LAND SURVEYOR'S REAL PROPERTY REPORT

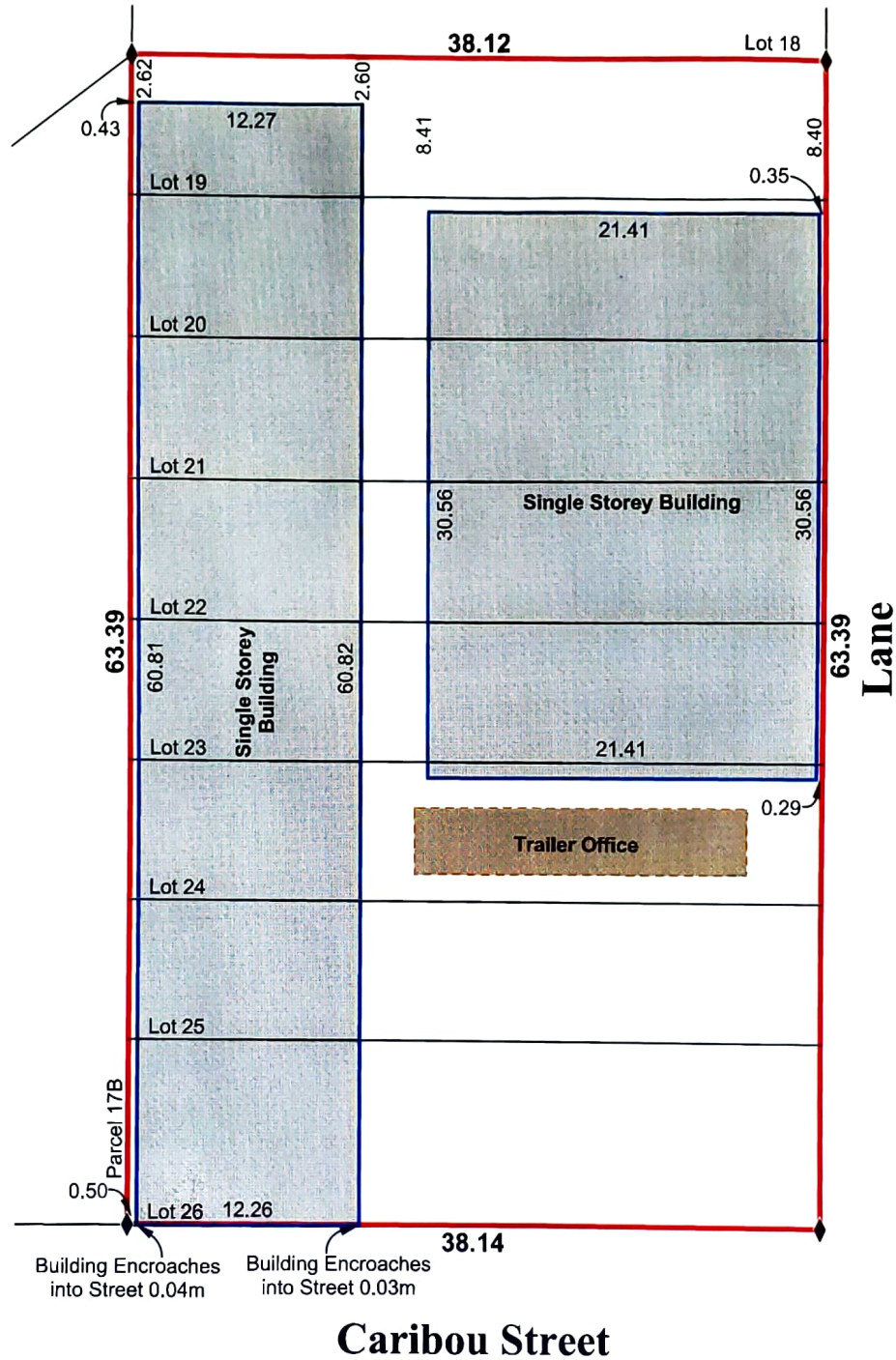

2017 ©

NOTE :

Unless otherwise specified, the dimensions shown relate to distances from property boundaries to exterior walls.

This document may not be reproduced without the written consent of the certifying Land Surveyor; further, it represents the conditions shown on the date of certification only.

All measurements are in metres.

Survey monuments found or planted are shown thus : _____

Property Boundaries of Parcel Affected shown thus : _____

Main exterior walls shown thus : _____

This Real Property Report is void if Page 1 does not bear an original signature and embossed seal, or if Page 1 is detached from Page 2.



Altus Geomatics

© 2017 Altus Geomatics

Toll Free: 1-800-465-6233
www.altusgeomatics.com

Scale - 1: 400

Initials: PF/RS - KS - JA

Field Book: Notes

Acad File: 204841RPR

Job No. : 204841

Page 2 of 2